

# Plug & play family

## Pure, elegant and simple



Puricom engineering team has developed a domestic reverse osmosis system absolutely different and advantageous:

**Plug & Play.** It's the simplest solution for domestic reverse osmosis water treatment. Switch on, fill the tank and ready.

**Eco-friendly.** A reverse osmosis system without water rejection. Total amount of water is usable.

**Hygienic.** FT cartridges and capsulated membrane assure a hygienic handling during maintenance actions.

**No-installation.** Save time. Zip doesn't require any hole, piping nor installation.

**Portable.** It can be carried and used in different residences and places.

**Washable.** Tanks can be unassembled easily in order to be washed properly.



## We create your plug and play products

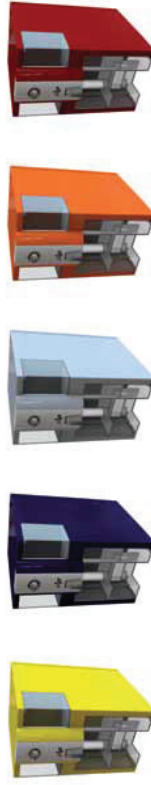

PURICOM is the world's leading manufacturer for customized products. From your colour, to your brand or your contact details...

**LET'S CREATE YOUR WATER.**

# Zip Plug & play family

- 

**Pressure pump**  
Greater production volume
- 

**Direct Access**  
Easy maintenance
- 

**Click**  
Connections are securely fastened and locked
- 

**Capsulated membrane**  
Minimum contact, maximum hygiene
- 

**Electronic adaptor**  
External, reliable, transformer
- 

**Open tank**  
Higher production and quality
- 

**Reliable connectors**  
Highly safe tubes and accessories
- 

**Ft filters**  
Hygienic, easy to maintain
- 

**Zero installation**  
No need for installation, no water connections
- 

**Eco friendly**  
Efficient water use, recyclable filters
- 

**Mineral**  
Mineralizing and pH increasing media
- 

**Plug & play**  
Ready to use



**Plug & play.**  
Installation is not required.

#### Certificates



**Description**  
4 stage system (5 µm, BLOCK carbon, capsulated Greenfilter membrane and pH increaser postfilter).

**Working parameters**  
Max. salinity 800 ppm.  
Bacteriologically potable inlet water.

**Membrane production.**  
8LPH, 800 ppm, 15°F, 20°C. Depending on the characteristics of the water.

## System components

<p><b>01. Pre-filters</b></p>	<p>Pre-filters are an essential part of a reverse osmosis system. They carry out an important treatment on inlet water in order to ensure that the reverse osmosis membrane can work under proper conditions, thus guaranteeing the quality of treated water.</p>
<p><b>Green filter</b></p>	<p><b>FT filters</b> ZIP series systems are equipped with FT filters. These state-of-the-art filtering cartridges make ZIP systems one of the most innovative reverse osmosis systems of the market. Thanks to its bayonet assembly, maintenance times can be reduced as well as contamination risk. Furthermore, its exclusive connection prevents the use from low quality spare parts, thus promoting the use of original filters and cultivating the loyalty of the client.</p>
<p><b>545900</b></p>	<p>FT-82 5 µm Sediment filter.</p>
<p><b>790353</b></p>	<p>FT-92 carbon BLOCK.</p>
<p><b>02. Reverse Osmosis membrane</b></p>	<p>It is the most important component of the system, since it determines, to a large extent, the quality of treated water. The Reverse Osmosis process is based on nature and has been used for more than 30 years. These semi-permeable membranes only allow nearly pure water to flow through, by removing excessive salts during the process. Likewise, it also rejects bacteria and micro-organisms, heavy metals, virus...</p>
<p><b>Green filter</b></p>	<p><b>717704</b> Capsulated GREENFILTER 75 GPD membrane</p>
<p><b>FLMITEC MEMBRANE</b></p>	<p><b>717705</b> Capsulated FLMITEC 75 GPD membrane</p>
<p><b>03. Post-filters</b></p>	<p>Post-filters allow the user to adjust the quality of osmosised water to its needs and tastes.</p>
<p><b>Green filter</b></p>	<p><b>FT Post-filters</b> High quality GREENFILTER filters, whose exclusive design permits a quick and easy maintenance.</p>
<p><b>790208</b></p>	<p>pH increaser filter.</p>
<p><b>04. Control and reliability</b></p>	<p>All PURICOM systems incorporate highly reliable control and safety devices in order to ensure a proper operation.</p>
<p>Incorporates PJK-261 microprocessed board, which controls the operation of the system.</p>	
<p><b>293500</b></p>	<p>Diaphragm pump UP-7000</p>
<p><b>294801</b></p>	<p>Outlet electrovalve 1/4" - 24VDC</p>
<p><b>294600</b></p>	<p>Quick connector check valve</p>
<p><b>05. Electronic controller</b></p>	<p>The electronic boards have been specially designed for PURICOM water treatment systems. Different models allowing multiple functions are available.</p>
<p><b>349212</b></p>	<p>PJK-261 Multifunction electronic board. Total control of the system and the interface.</p>
<p><b>349213</b></p>	<p>Timer Reliable and robust timer.</p>

## 06. Electrical connection

PURICOM has a wide range of connectors in order to suit the needs of each country.  
295207 Transformer 24 VCD 30 W - 1,25 A C type

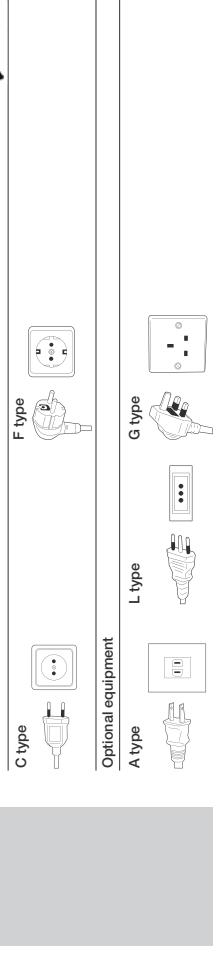

## Consumables for periodic maintenance



## Replacement frequency

1. 12 months.
2. 12 months.
3. 24 months <15 °HF.
4. 12 months.

These maintenance periods should only be used as a guideline. The distributor will determine the service life of consumables according to the water quality and the expected consumption.

## Features

### Start and stop of the system

This system is provided with a round dial switch for starting a cycle. The electronic board controls the tank placement and water level in. The system is blocked automatically if tank is not properly fitted or there isn't enough water.

### Front panel and interface

ZIP purifier has a blue and orange color coded, LED electronic control dial which integrates a timer, and security functions to efficiently manage the cycle and warnings.



Light indicators	Meaning	Light indicators	Meaning
	<b>Power on.</b> The system is waiting for a cycle.		<b>Working.</b> The system is in operation and treatment is in process.
	<b>Warning.</b> The lower tank is not mounted or set properly.		<b>Warning.</b> There is not enough water in lower tank or it is empty.

## Technical specifications

### Dimensions of the system

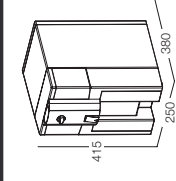

Logistics	Pallet
	Container 20'
	Container 40'
	23 units
	400 units
	840 units

Net / gross weight  
12 kg / 15 kg

These components can be configured.



Fishing light.